

INSTALLATION INSTRUCTIONS

DESCRIPTION: **Molded Sun Top Kit**

PART NUMBER: **2PG-K84A0-V0**

MODEL: **Viking VI**



DEALER:

Please give a copy of these instructions to your customer as they contain important information for future reference.

⚠ WARNING

Please read and understand these instructions completely before installation to avoid possible injury to yourself, or damage to the accessory or vehicle.

NOTICE:

This installation should be performed by an authorized Yamaha dealer or other qualified technician. We recommend this installation be done by a team of two or more people.

WARRANTY INFORMATION:

Genuine Yamaha accessories are covered by a one-year limited warranty against defects in material or workmanship. Labor for replacement of defective components is not covered. See your Yamaha dealer for a copy of the warranty statement.

PARTS LIST:

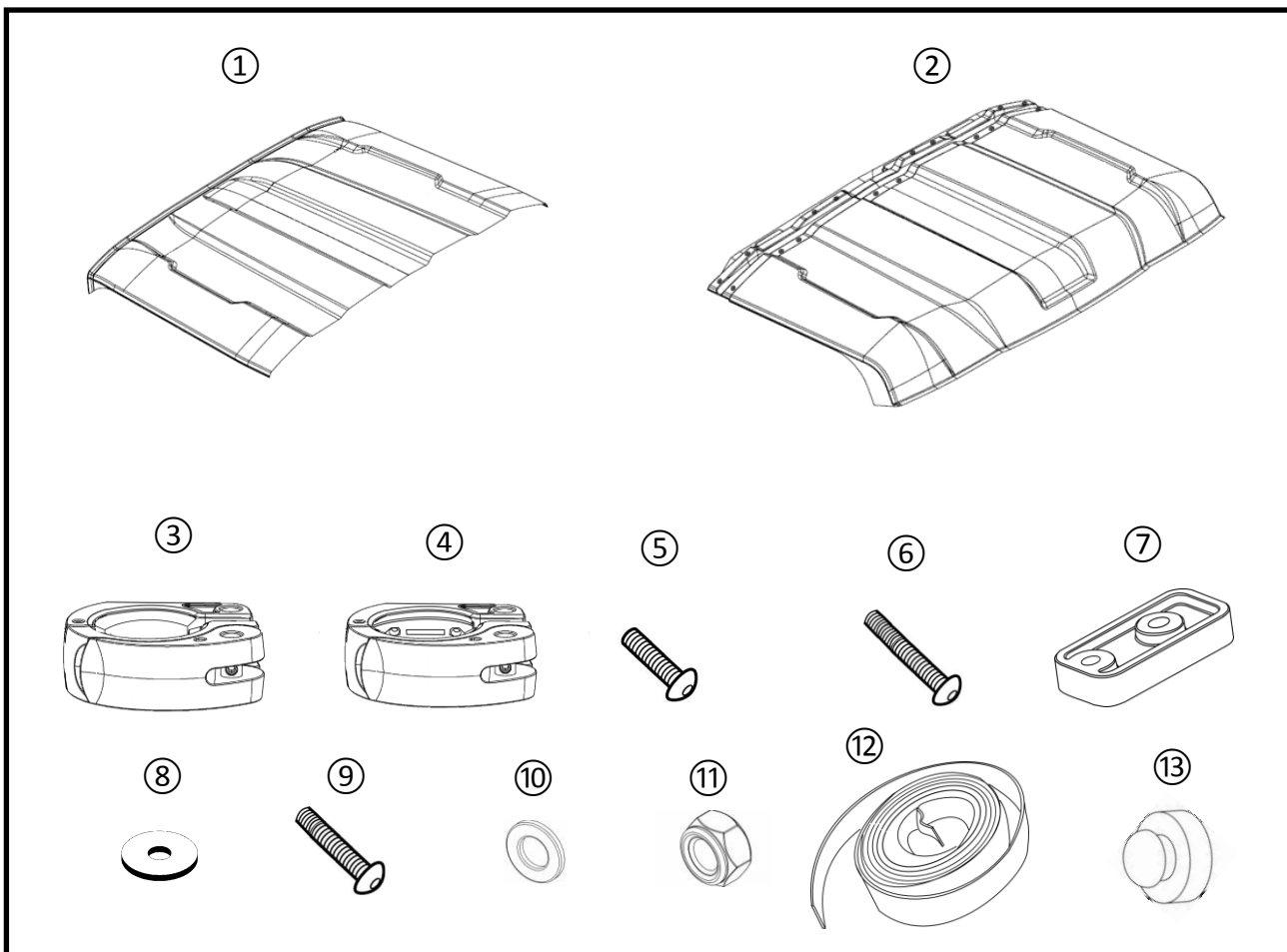

No.	Part Number	Description	Qty
--	2PG-K84A0-V0	Molded Sun Top Kit	--
①	*	Sun Top Front Section	1
②	*	Sun Top Rear Section	1
③	*	Clamp with Adapter	11
④	*	Clamp without Adapter	2
⑤	*	Button Head Screw (M6 x 16 mm)	18
⑥	*	Button Head Screw (M6 x 30 mm)	8
⑦	*	Spacer (0.5")	4
⑧	*	Fender Washer	50
⑨	*	Button Head Screw (M6 x 20 mm)	16
⑩	*	Flat Washer	8
⑪	*	Nylock Nut	16
⑫	*	Weather Strip	12 ft.
⑬	*	Grommet/Bumper	2

* Part supplied with kit only and not available separately.

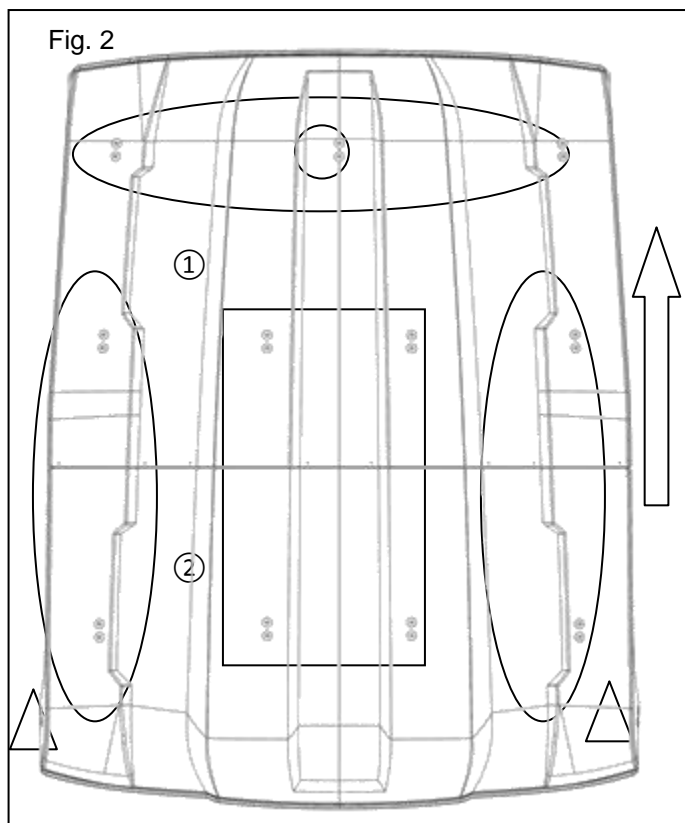
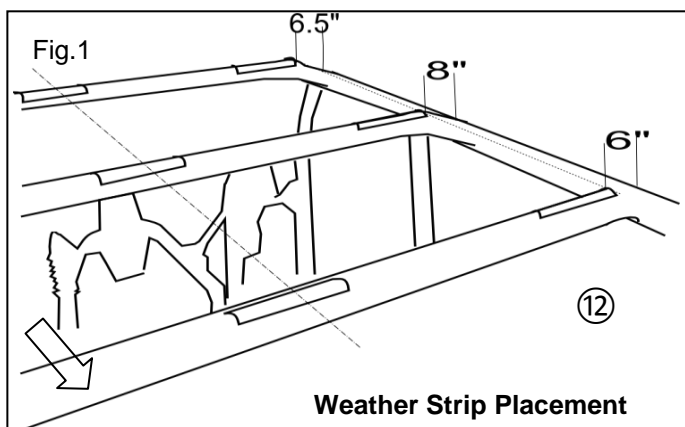

PREPARATION:

1. Place vehicle on a secure and level surface.
2. Set the parking brake.
3. Clean all mounting surfaces before installation.

INSTALLATION:

1. Measure and cut nine 9" (23cm) sections of weather strip ⑫. Also measure and cut one 5' 2" (157.5cm) section.
2. On the overhead crossbars, measure in from the outside edge of the cage/frame on both sides and apply 9" sections of weather strip as follows (see Fig. 1):
 - Front: 6" (15.25cm)
 - Middle: 8" (20.5cm)
 - Rear: 6-1/2" (16.5cm)
 Also apply a 9" section at the midpoint of each bar.
3. Attach clamps with adapters ③, with the end of the clamp lever pointing forward when closed (see Fig. 3), to the two sections of roof for the mounts inside the three "ovals" in Fig. 2 (except the front center one shown circled). Use two M6 x 16 mm button head screws ⑤ and two fender washers ⑧ (see Fig. 4).

TIP: Leave all clamp assemblies just finger tight now to allow for some adjustment.

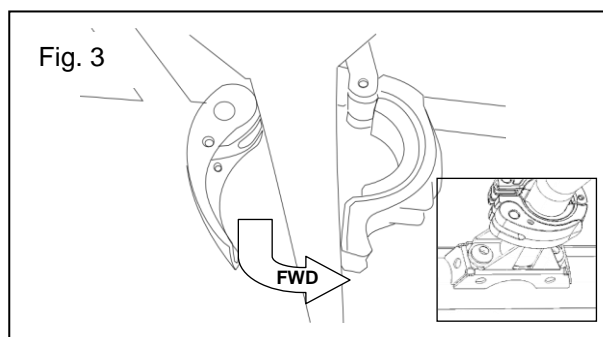

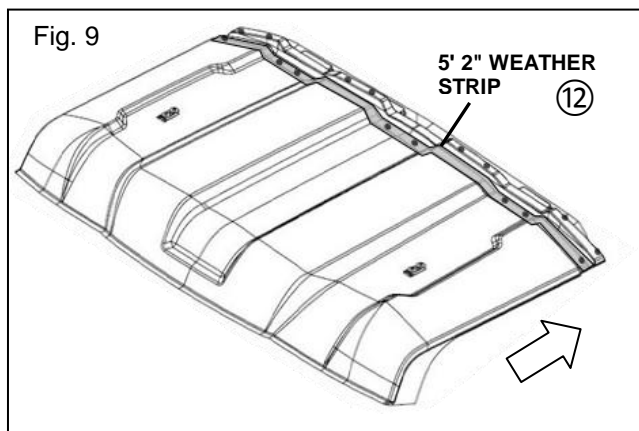
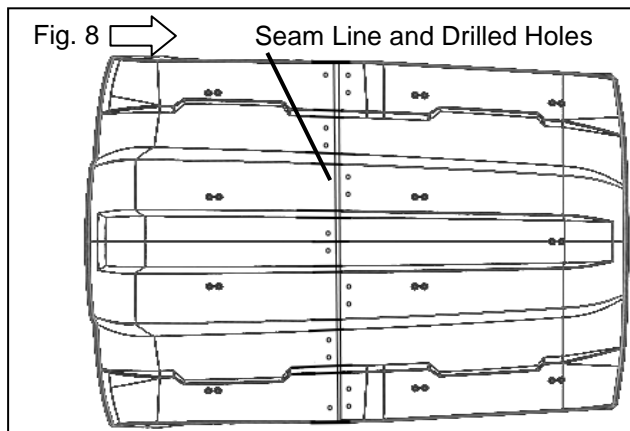
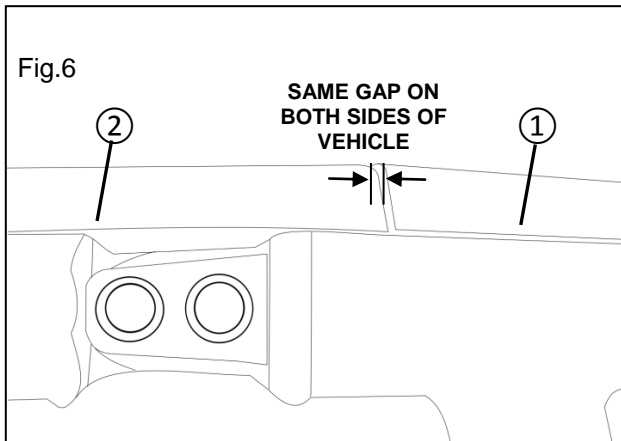
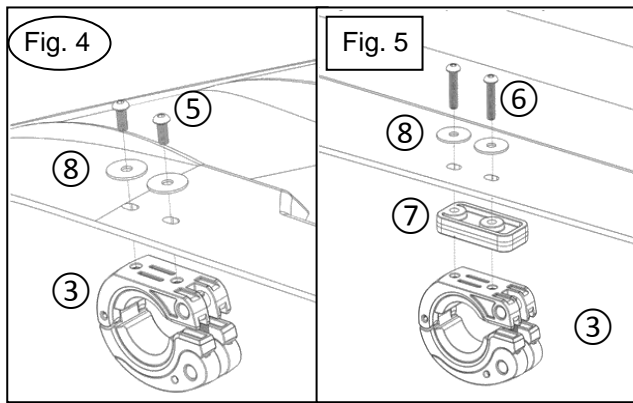

4. Install the center-front clamp (3) (shown circled in Fig. 2) as above, but facing to the rear. This will allow installation of the overhead sound system (if installed now or later).
5. Refer to Fig. 2 for the four mounts inside the "rectangle" area. For each, assemble and install a clamp with adapter (3), two M6 x 30 mm button head screws (6), two fender washers (8), and one half-inch spacer (7) (see Fig. 5) with the end of the clamp lever pointing forward when closed (see Fig. 3)
6. Open all installed clamps and, with two people, set the rear panel (2) on roof supports.
7. Open all clamps and set the front panel (1) on the roof supports, overlapping the rear panel.

TIP: Slide front panel (1) back enough to clear the windshield, if installed.

8. Center roof panels (1) & (2) side to side.
9. Move rear panel as needed to get a uniform gap on both sides at the top mating surface of front (1) and rear (2) panels (see Fig. 6).
10. Close all clamps on the underside, then tighten all button head bolts on the top side to 4.5 Nm (45 cm • kgf, 40 in • lbf).
11. From the underside of the top, locate the 16 existing holes in the (2) rear roof. Drill 16 holes up through the front section using a 6mm or 1/4" drill bit. See Fig. 8, along the seam line, for the approximate locations of these holes.
12. Loosen the clamps on both panels (1) & (2) and then remove the rear panel from the vehicle. Apply the 5' 2" section of weather strip to the top front lip of the rear panel (as shown shaded in Fig. 9).
13. Carefully poke through the weather strip with an awl or screwdriver.
14. Reinstall the rear section on the vehicle with the front section overlapping the rear section, closing up the gap as before. Lock the clamps again.

Fig. 10

Cross section of seam between ① and ② - See Fig. 8

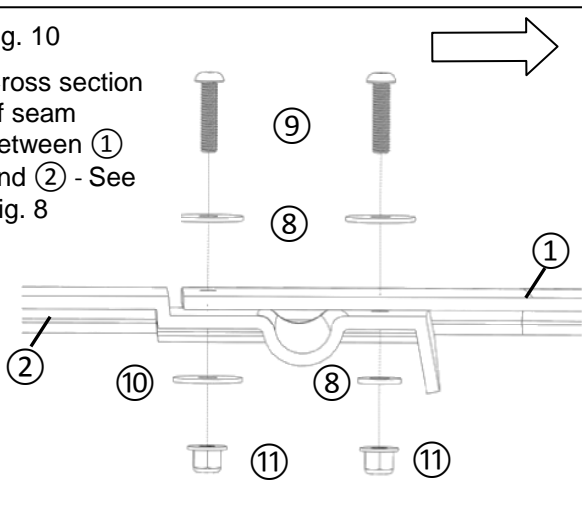

Fig. 11

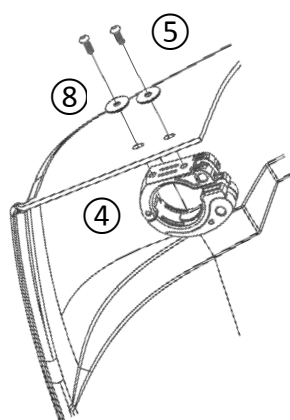

Fig. 12

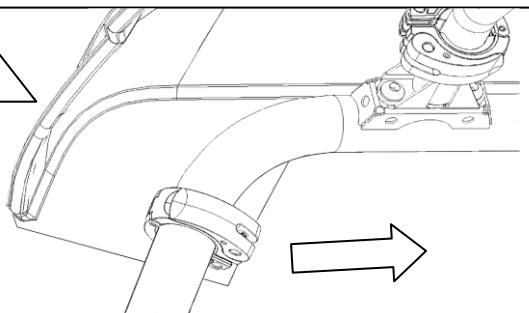
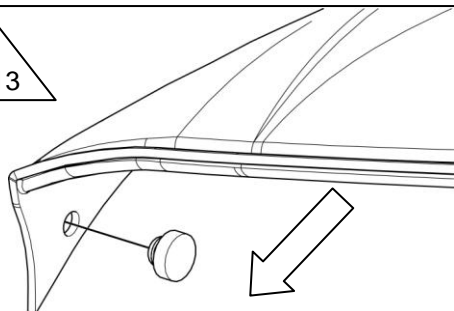

Fig. 13



15. From the topside, install an M6 x 20 mm button head screw (⑨) and one fender washer (⑧) into each of the drilled holes. (Fig. 10)
16. From the underside of the roof, install one flat washer (⑩) and one nylock nut (⑪) to each screw in the row closest to the front end of the vehicle.
17. Install a fender washer (⑧) and nylock nut (⑪) to each remaining screw (Fig.). Torque nylock nuts to 6 Nm (0.6 m • kgf, 4.3 ft • lbf).
18. Use Fig. 2 to locate the two rear mounts marked by "triangle" areas. Install a clamp (④) without adapter with two M6 x 16 mm screws (⑤), and two fender washers (Fig. 11) with the end of the clamp lever pointing to the back when closed. See Fig. 11 and Fig. 12 for more detailed views of the mount location and position. Torque to 4.5 Nm (46 cm • kgf, 40 in • lbf).
19. Install a (⑬) bumper/grommet from the inside, into the holes on the sides of the front section (Fig. 13).

MAINTENANCE:

Check and adjust as necessary.

CARE AND CLEANING:

Wash with a mild soap and water solution using a soft cloth.

CUSTOMER SERVICE:

For further information see your Yamaha dealer.

ESTIMATED TIME TO INSTALL: 1.5 HRS